

Sophia Mail
- Setting Manual for Smartphone -

Feb. 5, 2018

Sophia University ICT Office

Contents

- 1. iPhone/iPad/iPod (iOS11) 3
- 2. Android 4.x(smartphone, tablet)..... 6

1. iPhone/iPad/iPod (iOS11)

(1) [Settings] - [Accounts & Passwords]

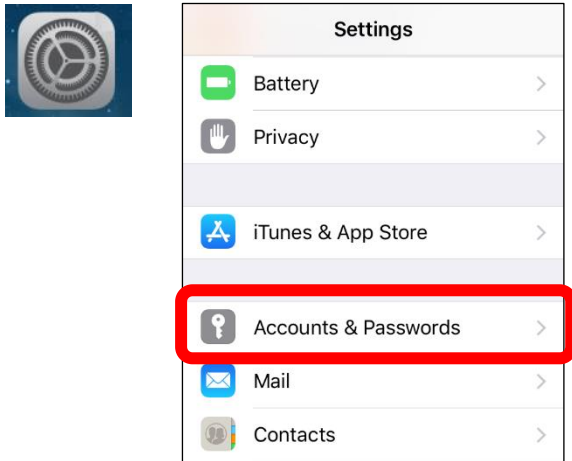

(2) Select [Add Account...].

(3) Select [Exchange].

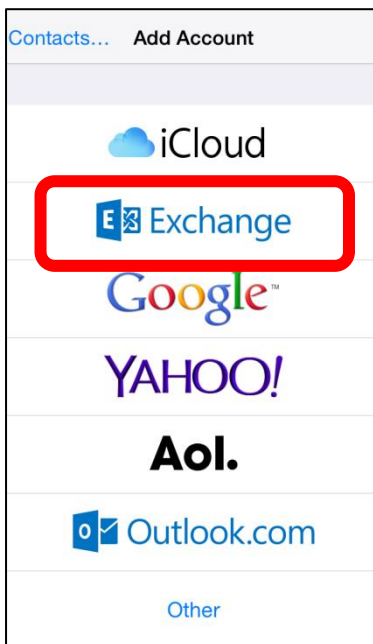

(4) Enter Email. Then tap [NEXT].

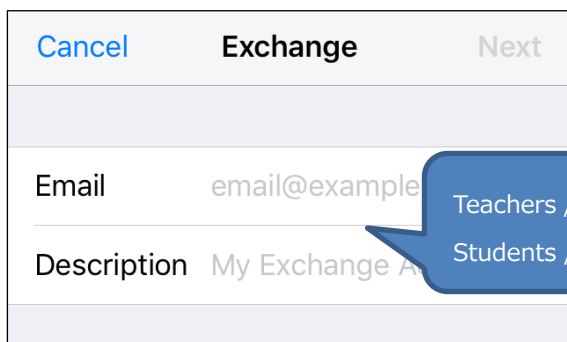

Email	Teachers /Staff /Emeritus professors : <u>OOOO</u> @sophia.ac.jp Students /Retired Faculty Members : <u>OOOO</u> @eagle.sophia.ac.jp
-------	---

(5) Confirmed dialog for Exchange account will appear and click “Configure Manually”.

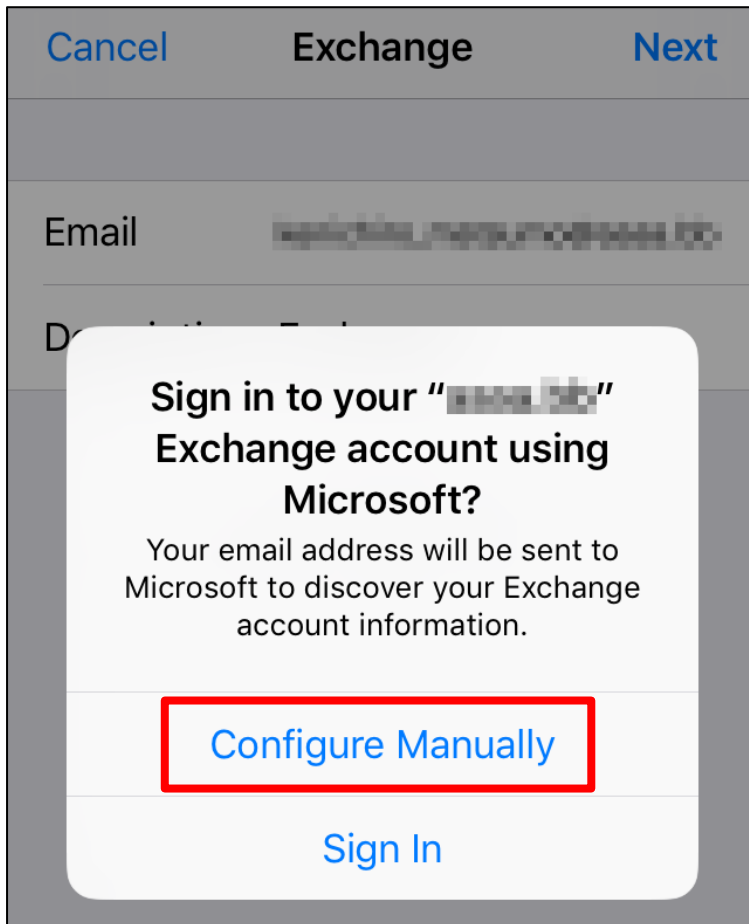

(6) Enter Email and Password. Then tap [Next].

Email	Teachers /Staff /Emeritus professors : <u>OOOO</u> @sophia.ac.jp Students /Retired Faculty Members : <u>OOOO</u> @eagle.sophia.ac.jp
Password	Password for Sophia mail

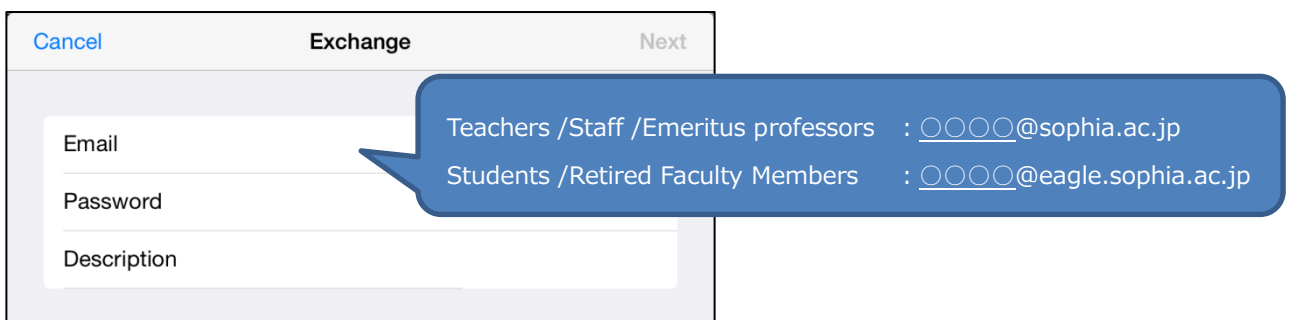

(7) Enter Server, Username and Password. Then tap [Next].

Server	outlook.office365.com
Username	Teachers /Staff /Emeritus professors : ID Number@sophiamail.sophia.ac.jp Students /Retired Faculty Members : ID Number@eagle.sophia.ac.jp
Password	Password for Sophia mail

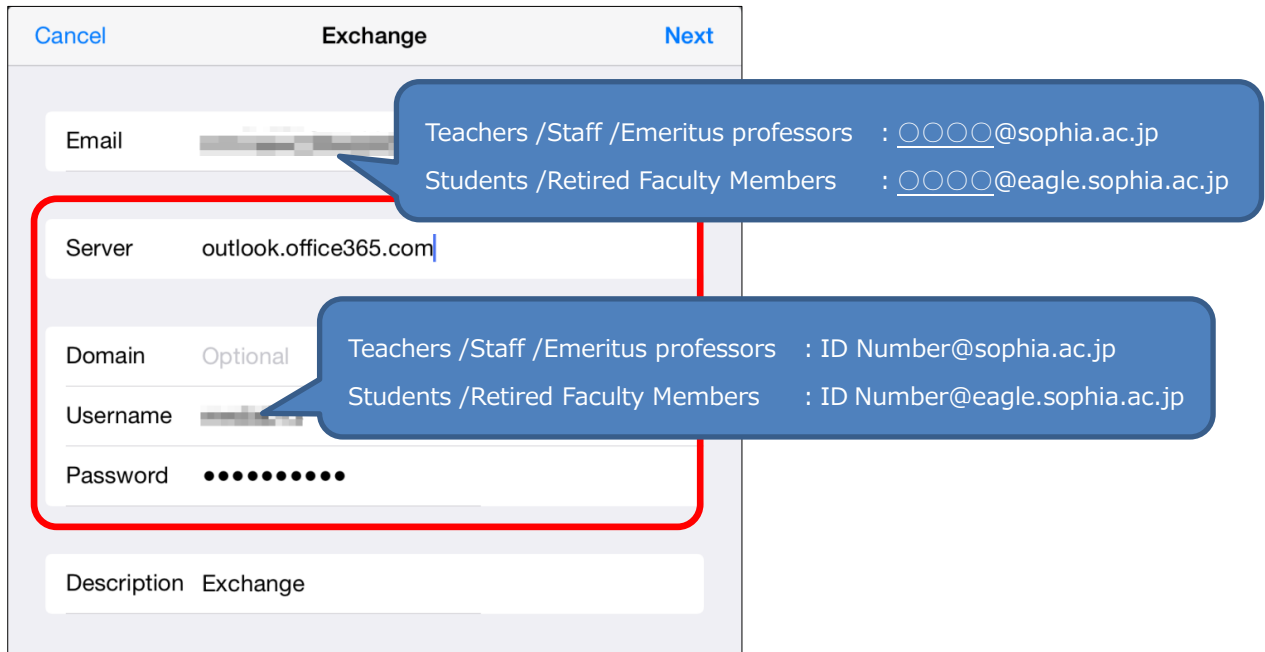

(8) Tap [Save].

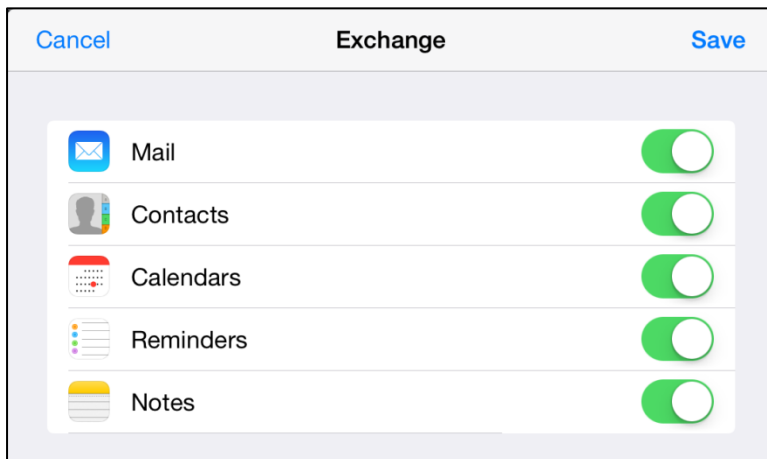

2. Android 4.x(smartphone, tablet)

Settings' screens depend on each device. Please refer to the manual of your device and set up your device as follows.

- (1) Start [Email] application and open [Settings] and select [Add account].



- (2) Enter Email address and Password. Then tap [Next].

Email address	Teachers /Staff /Emeritus professors : ○○○○@sophia.ac.jp Students /Retired Faculty Members : ○○○○@eagle.sophia.ac.jp
Password	Password for Sophia mail

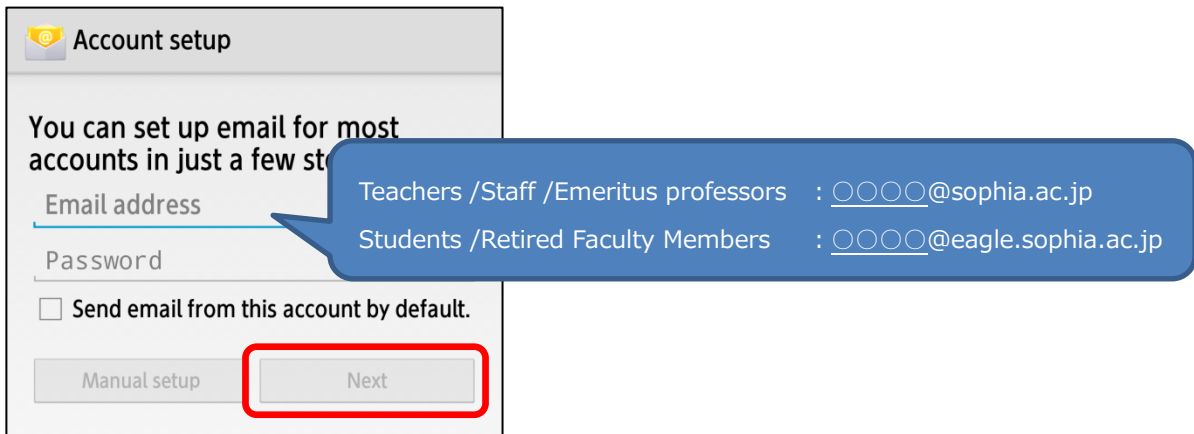

- (3) Select [Exchange] or [Exchange ActiveSync].

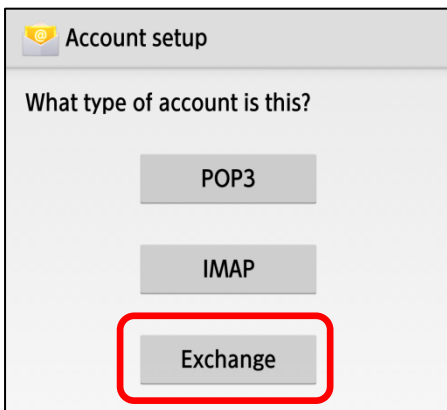

- (4) Enter Domain¥Username, Password and Server. If any character strings are already entered, please delete them and enter following information.

Then tap [Next].

Domain¥Username	Teachers /Staff /Emeritus professors : ID Number@sophia.ac.jp Students /Retired Faculty Members : ID Number@eagle.sophia.ac.jp
Password	Password for Sophia mail
Server	outlook.office365.com
Use secure connection (SSL)	CHECK the box

Teachers /Staff /Emeritus professors : ID Number@sophia.ac.jp
Students /Retired Faculty Members : ID Number@eagle.sophia.ac.jp

- (5) When the following pop-up about security appears, please tap [OK].

- (6) Please check/uncheck the following boxes as you want and tap [Next].
 Default setting of 'Days to sync' is 'Last week'. Please change it if necessary.

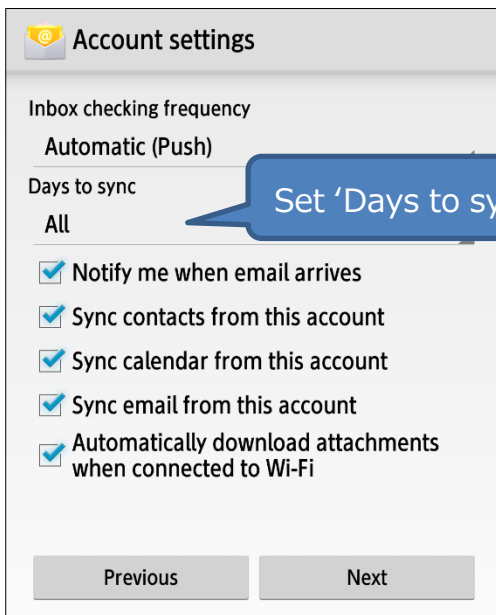

- (7) Please set account name (optional). Then tap [Next].

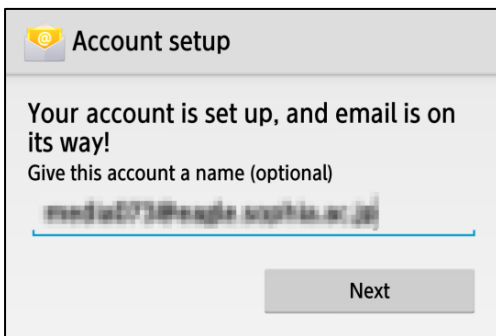

- (8) When the following screen about device administrator appears, please tap [Activate].

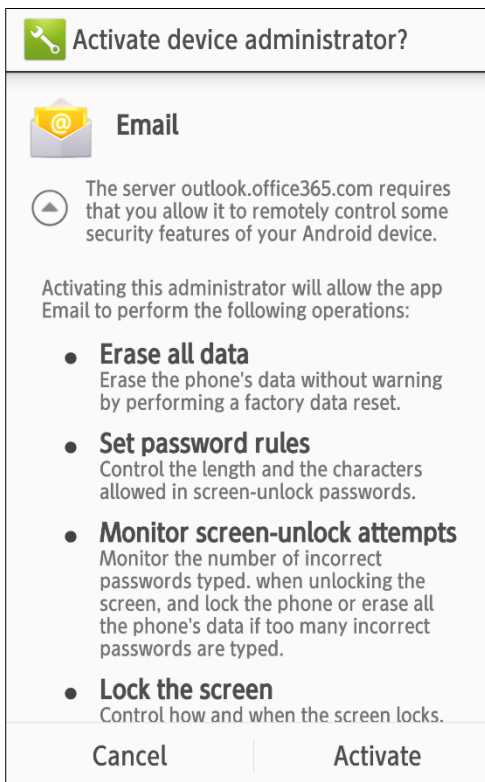

Sophia Mail
- Setting Manual for iOS and Android –

Published in Jan. 10, 2016
Revised in Feb. 5, 2018

Sophia University ICT Officer
7-1, Kioi-cho, Chiyoda-ku, Tokyo, 102-8554
Telephone: 03-3238-3101
URL: <http://ccweb.cc.sophia.ac.jp>

Sophia ICT

Search