

Please operate the equipment inside the AV wagon.

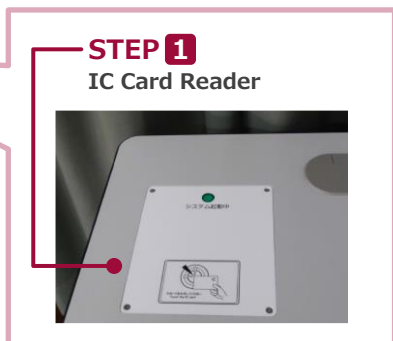

AV Wagon

**STEP 1**  
IC Card Reader



**Emergency Key**

If the system can not be booted from the IC card, Please use this to start.



Blu-ray/DVD Player

**STEP 2 4**  
System Switcher

**STEP 3**  
AUX Panel

**STEP 3**  
Storage Space

DO NOT TOUCH



Inside the Wagon

**1 System Start-Up**

Touch your IC card to the reader.

IC Card Reader



System ON / Door's Key is Unlock

**2 AV Presentation**

Open the door of the wagon and operate the control panel.

① Video Source Select ② MIC Volume ③ AV Volume ④ System Shut Down

※Long Press

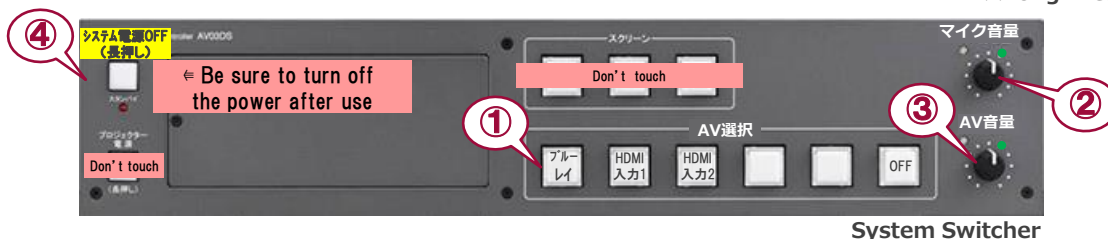

System Switcher

**3 Connecting Your BYOD Devices**

■ Connect your BYOD device to the HDMI INPUT (AUX panel) .

**If you use a laptop PC, charge the output setting.**

The Cable is stored in the drawer.

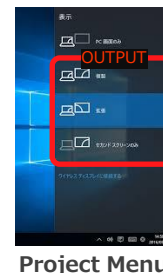
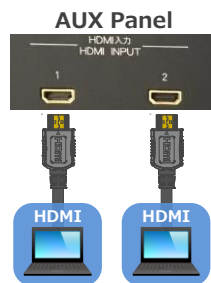

How To Open "Project" menu

《Windows 10》

『Windows Key』 + 『P』



- Duplicate : Duplicate Desktop on Display.
- Extend : Extend Desktop to Display.
- Second screen only : Display Only.

- Connect to wired microphone to the MIC INPUT. (Auxiliary)
- Connect to music player to the AUDIO INPUT.

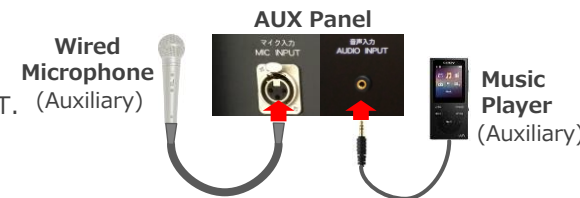

**4 System OFF**

Press **Shut Down button ( ④ )** and **Close the Wagon's Door.**

※If you use Emergency Key, Please do not press Shut Down Button.

Turn off Emergency Key, and Close the Wagon's Door.