

Please operate the equipment in the AV Control Desk, following the right.

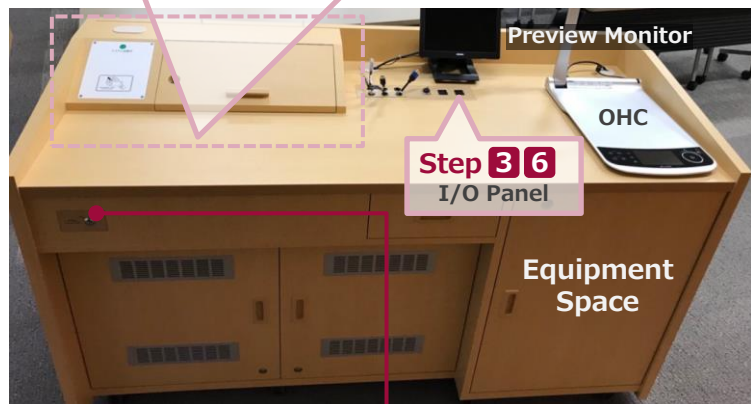

Emergency Reboot Key
If the system cannot be started up by IC Card, Use the key.

AV Control Desk

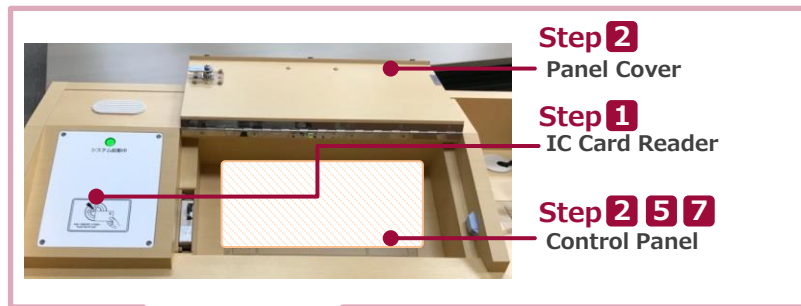

Equipment Space

1 Startup System

Hold IC Card over IC Card Reader.



※If you don't have IC Card, use the Emergency Reboot Key.



System ON / The door's key and Panel Cover OPEN

It's possible to use microphones when the system has been started.
⇒Procedure is the back.

2 Startup the other equipment

Open the Panel Cover, operate the Control Panel.

- ① Projector Power ON/OFF
- ② Video output source select: Screen, Preview Monitor and more
- ③ The audio output source to speakers select
- ④ Volume control
- ⑤ Screen operation
- ⑥ System OFF
- ⑦ Turn ON/OFF the 203a speaker

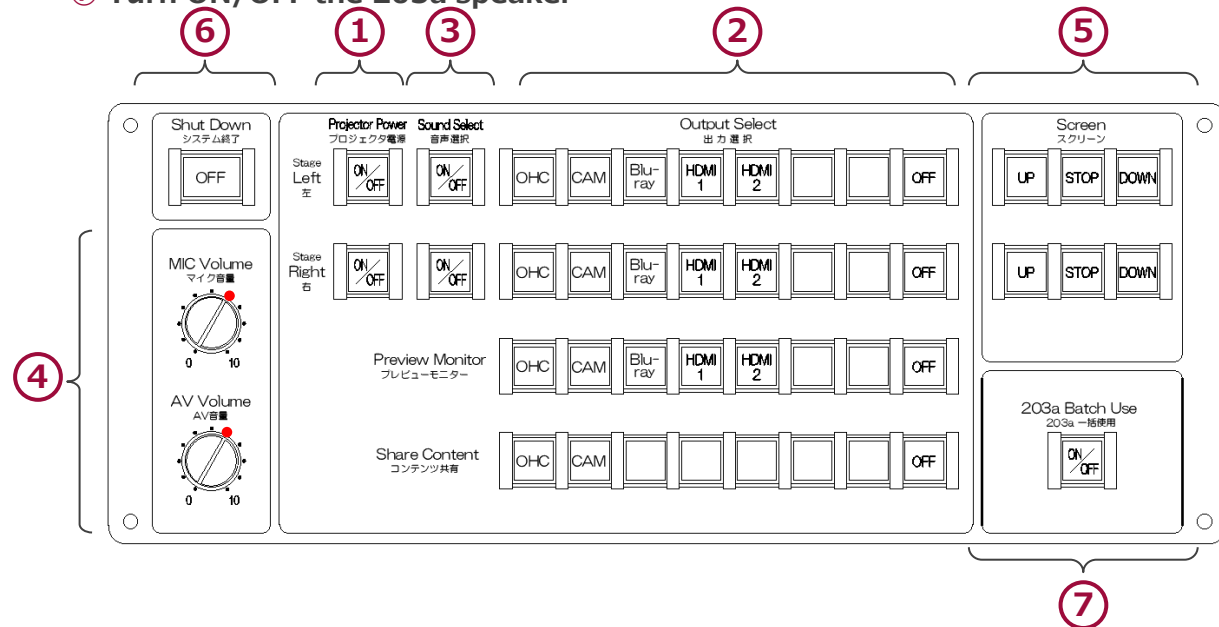

3 Connect BYOD

Insert the cable of the I/O Panel to your HDMI device and your PC.

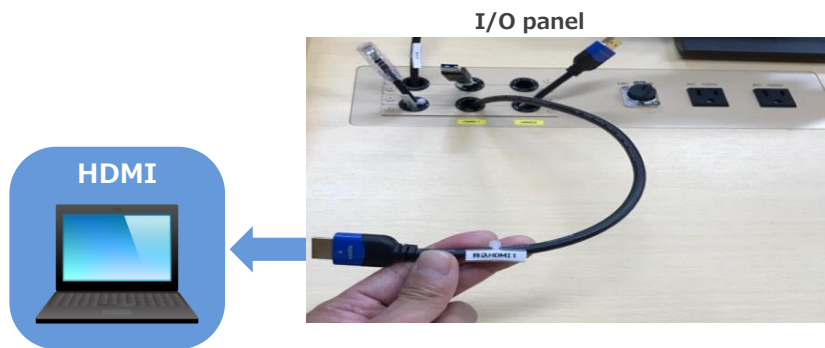

If you use your PC, change the output setting to "External."

External output setting select



- Duplicate : PC and Screen are same.
- Extend : PC and Screen are used like a dual display.
- Projector Only : Screen only

How to open second screen menu

《Windows 10》
『Windows key』 + 『P』



《Except for Windows 10》
List: Computer makers and corresponding keystroke.

Fn + F2	MSI
Fn + F3	NEC, Panasonic, SOTEC, MITSUBISHI, Everex
Fn + F4	HP, Gateway
Fn + F5	ACER, TOSHIBA, SHARP, SOTEC
Fn + F7	SONY, IBM, Lenovo, HITACHI
Fn + F8	DELL, ASUS, EPSON, HITACHI
Fn + F10	FUJITSU

※Please check the detail by user manual you used.

4 Use Wireless and Wired microphone

Open the door of AV Control Desk, take microphones out and power on.
Connect **Wired Microphone(bringing)** to the **I/O Panel**.



※ **Make sure to return to the Microphone Charger** after using.

5 Control Volume

Volume is set at best level in advance.
If you need to control it, please operate **Volume Control** on the **Control Panel**.



MIC Volume
Control volume of Wireless MIC and Wired MIC(bringing).



AV Volume
Control volume of Video: Blu-ray, PC and more.

Restore original level(●) after using.

AV Control Desk



Step 6
USB cable



Camera Controller
※In the drawer※

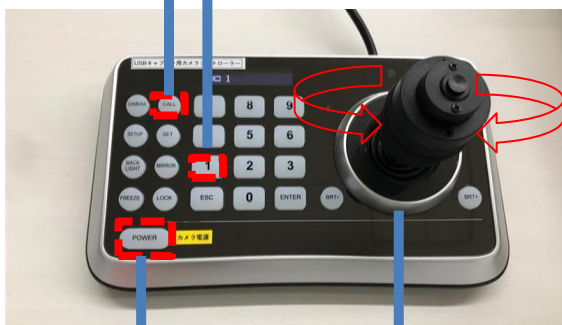

6 Start Live Streaming Lectures

Insert the USB cable and the HDMI cable into a PC, select any contents you want to share. Set up any web meeting application: Zoom, Microsoft Teams and more.

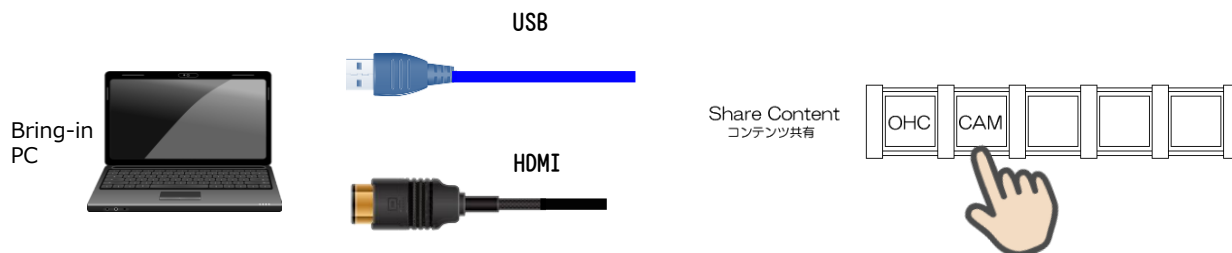

Change the PC setting about the output devices.

- Microphone
⇒ Digital audio interface
- Camera
⇒ UB3300 USB Video Capture
※ When you use Zoom, uncheck "Mirror my video."
- Speaker
⇒ MSD-804FD (※)
※ Display name is different by any connecting device.
Select any audio output device connecting by HDMI cable.

Operate the camera by the controller in the drawer.

1. Press ③ button to set up if the camera faces the rear.
The camera usually faces the front and keeps driving, don't need to do anything.
2. Press ② and ①, the angle of view is switched automatically, following the presets registered as any numbers.
3. Adjust the angle of view by Joystick(④).
Twisting Left: Zoom out, Twisting Right: Zoom in.
Pushing Left/Right/Up/Down: Pan/Tilt.
4. Don't press ③ when you finish the system.

7 System OFF

Press **Shut Down Key** in Control Panel, close Panel Cover and AV Control Desk's door.

