

Please operate the equipment inside the AV control desk.

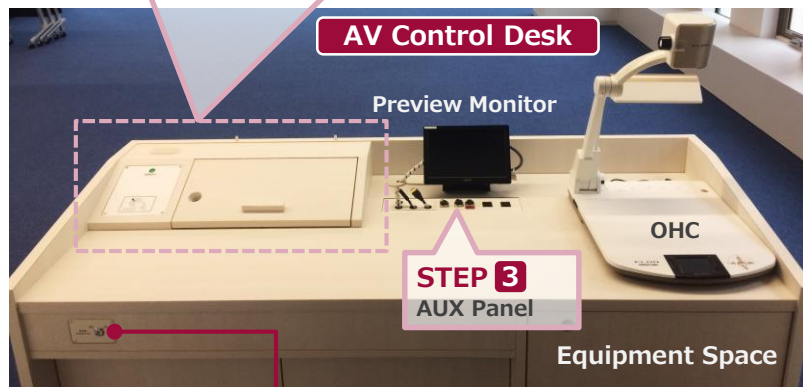

Emergency Key

If the system can not be booted from the IC card, Please use this to start.

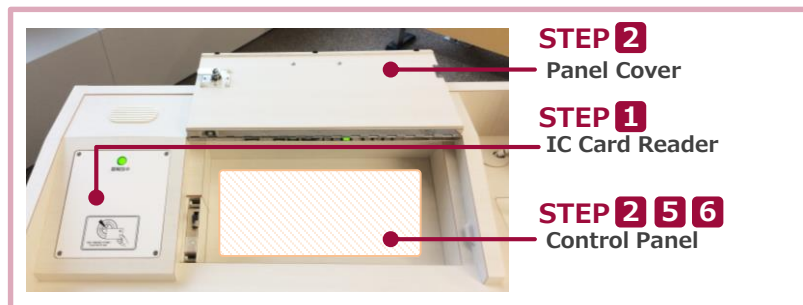
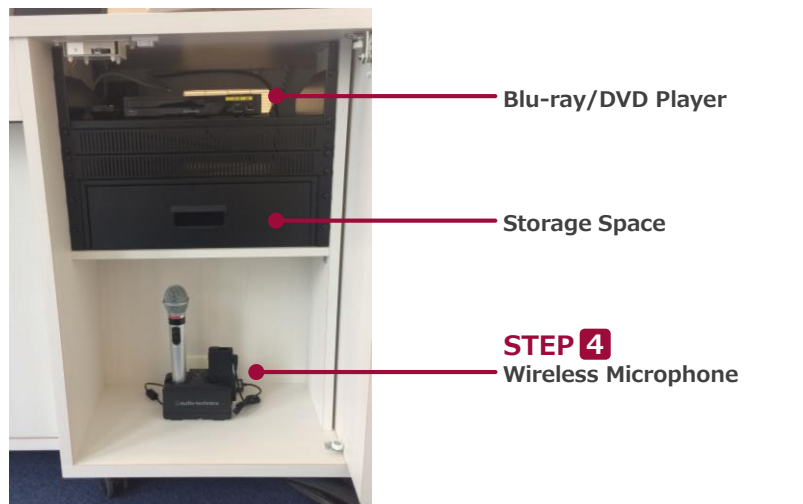

Equipment Space

1 System Start-Up

Touch your IC card to the reader.



2 AV Presentation

Open the panel cover of the desk and operate the control panel.

- ① Projector Power ON/OFF ※The screen goes down at the same time as ON.
- ② Video Source Select
- ③ Audio Volume
- ④ Screen Control
- ⑤ System Shut Down

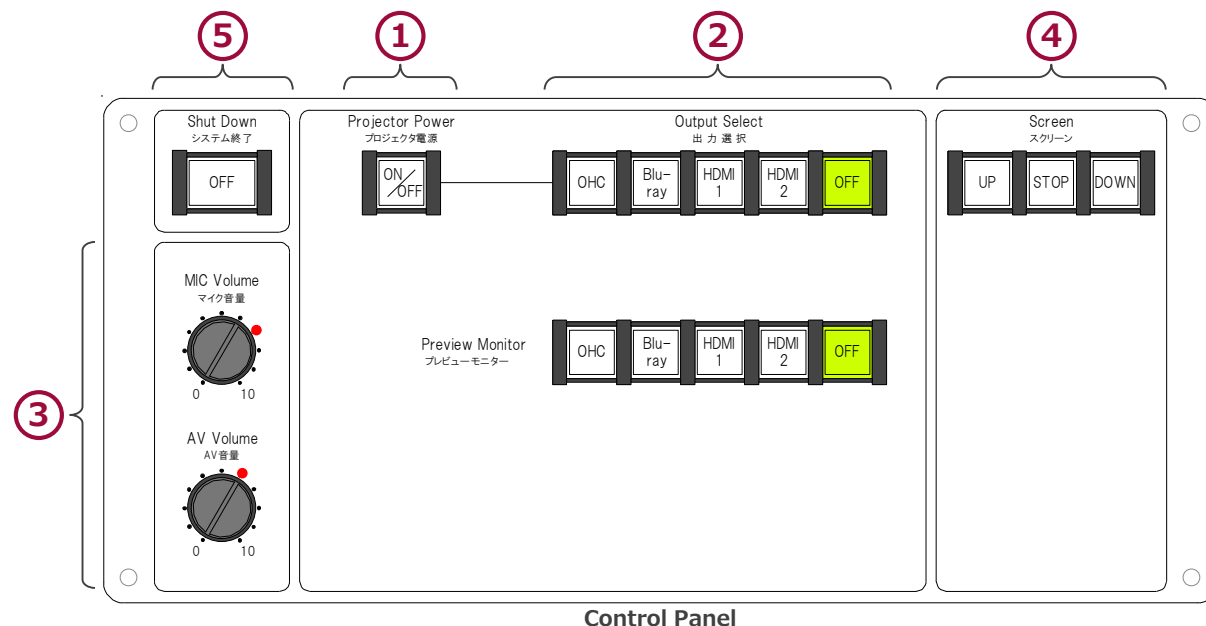

3 Connecting Your BYOD Devices

Connect your BYOD device to the AUX panel.

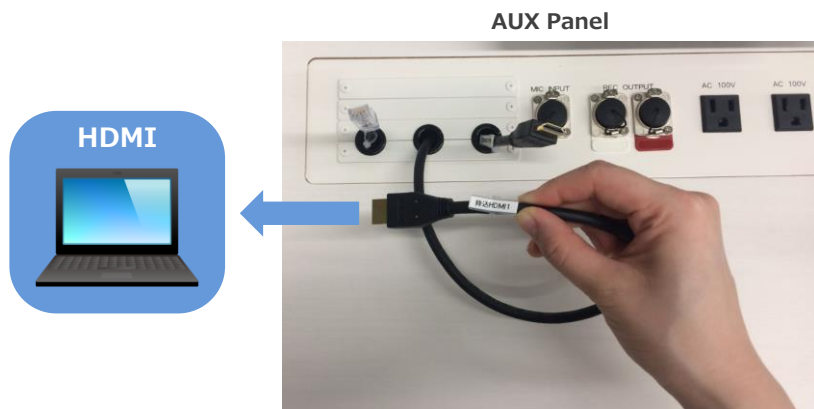

If you use a laptop PC, charge the output setting.

Projector Display Menu



- **Duplicate** : Duplicate Desktop on Projector.
- **Extend** : Extend Desktop to Projector.
- **Projector Only**

How To Open Projector Display Menu

《Windows 7》

Press 『Windows』 + 『P』



《Not Windows 7》

Fn + F2	MSI
Fn + F3	NEC, Panasonic, SOTEC, MITSUBISHI, Everex
Fn + F4	HP, Gateway
Fn + F5	ACER, TOSHIBA, SHARP, SOTEC
Fn + F7	SONY, IBM, Lenovo, HITACHI
Fn + F8	DELL, ASUS, EPSON, HITACHI
Fn + F10	FUJITSU

4 Use Wireless Microphone and Auxiliary Wired Microphone

Take out the microphone charger and turn on the microphone. Connect to wired microphone to the AUX panel.

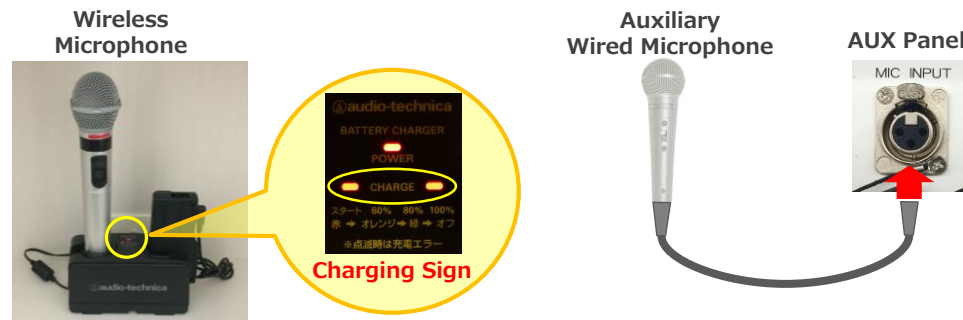

Make sure to return to the microphone charger after using the microphone.

5 Audio Volume Control

The volume is adjusted to the optimum level beforehand.

When adjustment is necessary, please operate the volume knob on the control panel.



MIC Volume

Wireless microphone and Wired microphone



AV Volume

Video audio (Blu-ray, Laptop PC etc.)

Please return to the original level (●) after using the system.

6 System OFF

Press **Shut Down button** on Control Panel and **Close the Desk's Door**.

