

Operate the equipment in the Wagon. Follow the steps on the right.

**Wagon - Top surface**

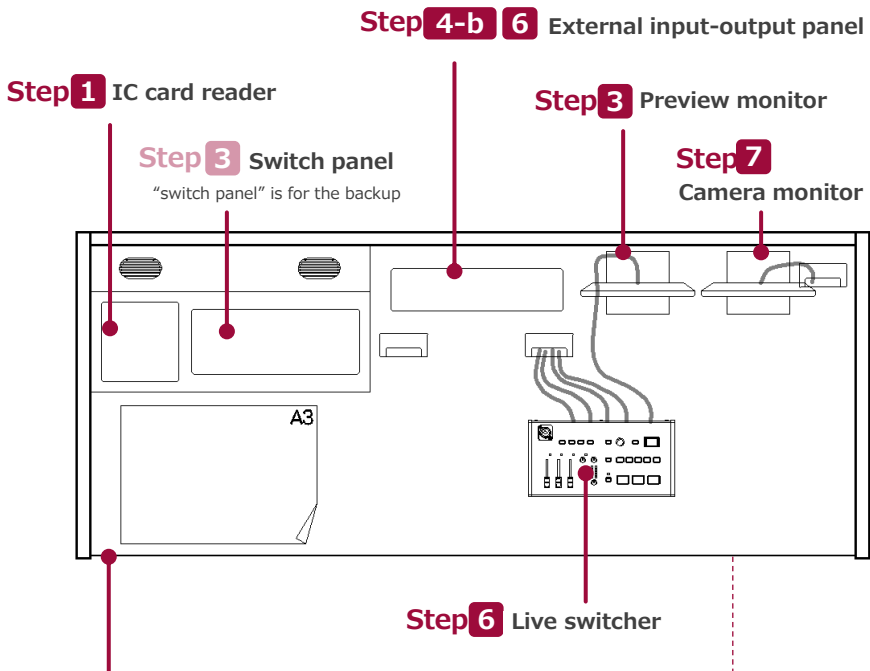

**Emergency Switch** (side of the Wagon)

Switch the button if IC card reader don't work

**Wagon (right side)**

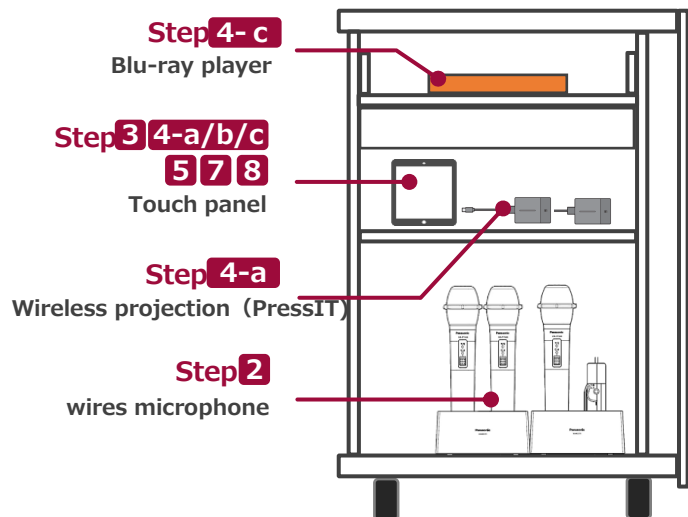

**1 Start the system**

It holds up the 'IC card' in the IC card reader.

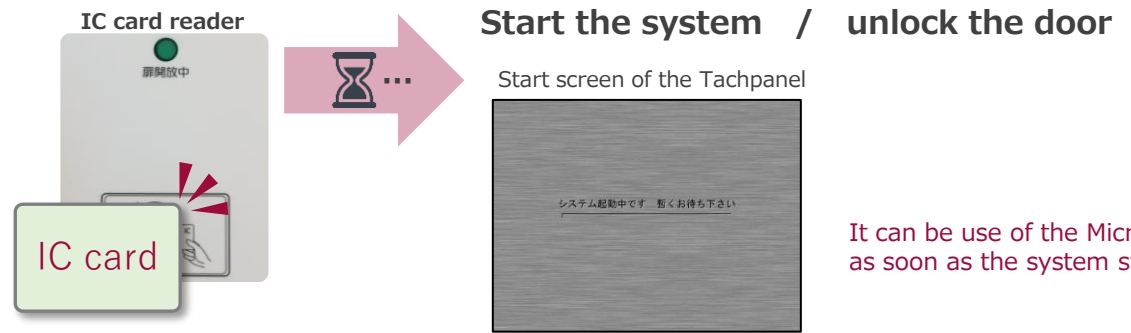

**2 Use of the Microphone "Wires" or "bring our Wired microphone".**

It removes the wires microphone from the charger and turns on the power of the main unit.

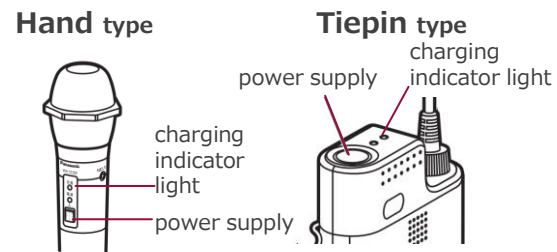

※After use it, it can please be sure to put it back into the microphone charger.

[charging indicator light of the main unit]

- lighting : charging
- lights out : charging complete or Not properly set in the charger
- flashing : error



It connects to the "External input-output panel" with bring wired microphone

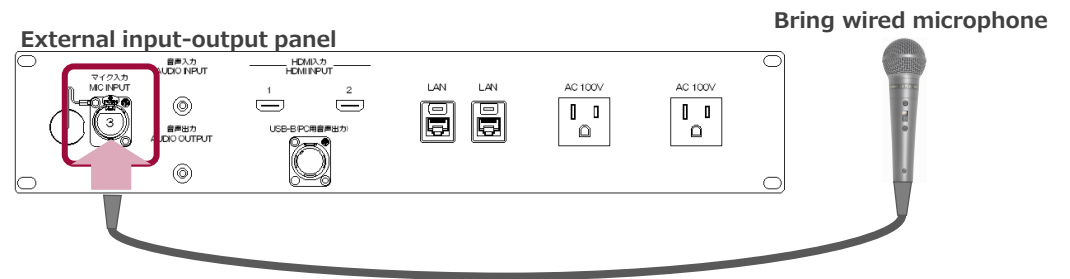

### 3 AV機器を使用する

It can use touch panel basically. \* Switch panel is for the backup.

\* It's also possible to operate from the "switch panel" interlocking the touch panel.  
The function of "Switch panel" is Projector Power ON/OFF, Select the volume output, Select the Video output and operate the screen.

- ① Select the Video Output to Screen
- ② Basic operation of "Blu-ray/DVD player"
- ③ Camera operation
- ④ Adjust the volume -Microphone/video volume-
- ⑤ Adjust the individual volume
- ⑥ Shut down the system

Homepage on the touch panel

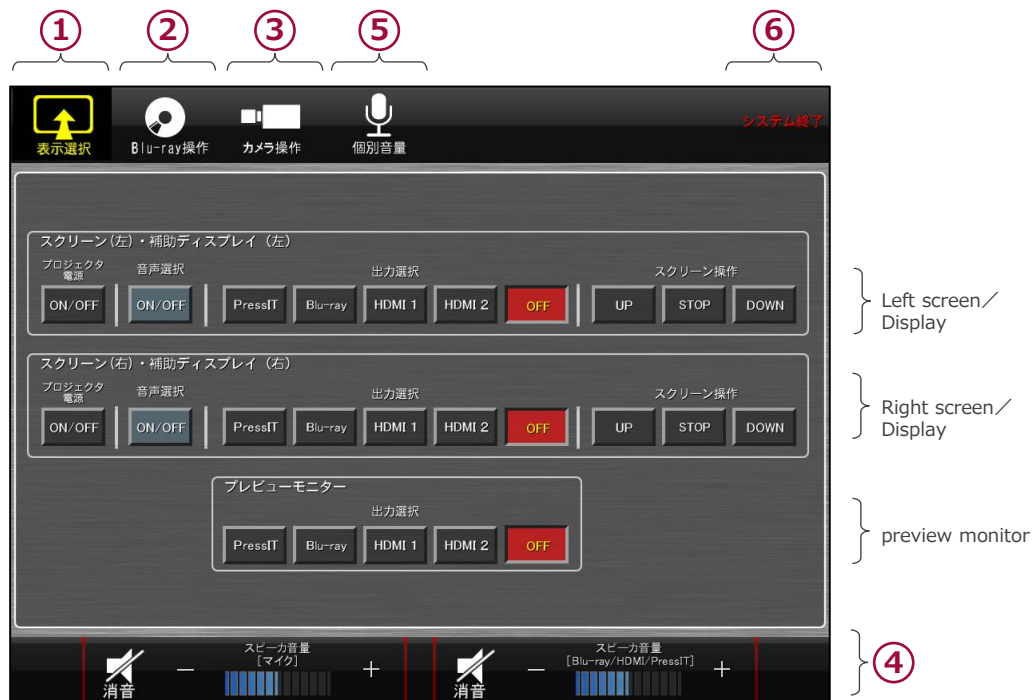

### 4-a Wireless projection (PressIT)

It connects the Extender for wireless presentation with your laptop.

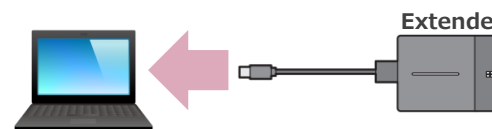

Follow the under about Extender after connecting laptop

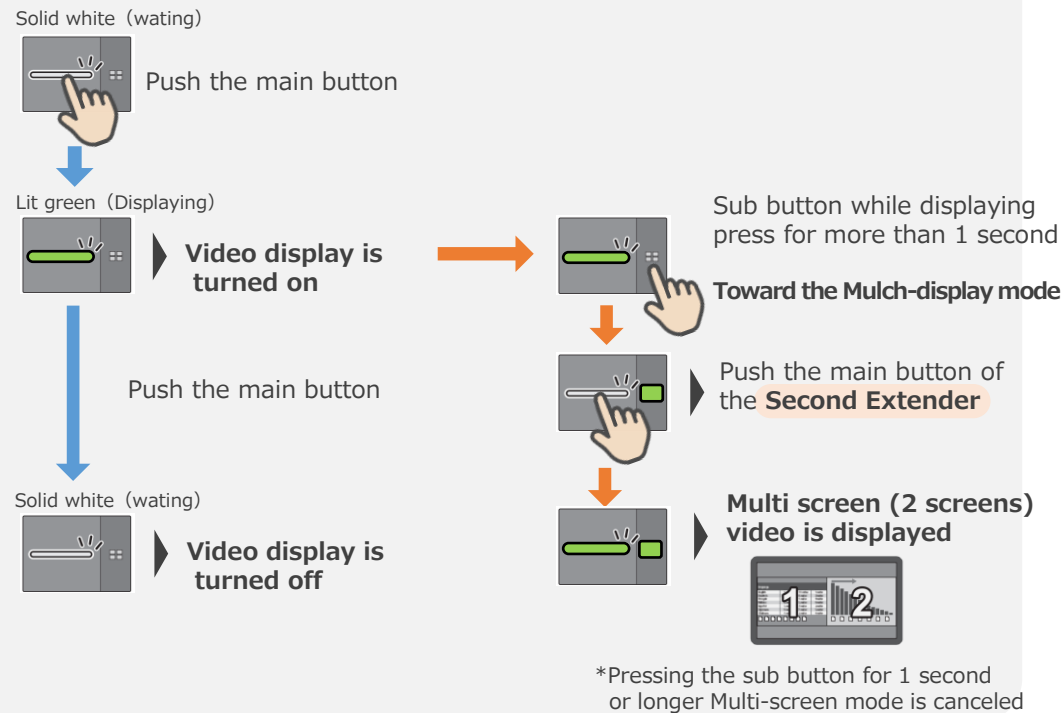

It can display the screen when you tap on the [Output Select] from the touch panel or select the [PressIT] of the "switch panel"



4-b Connect the Bring-in devices

It connects the "HDMI cable" to the "External input/output panel" and your equipment or laptop.

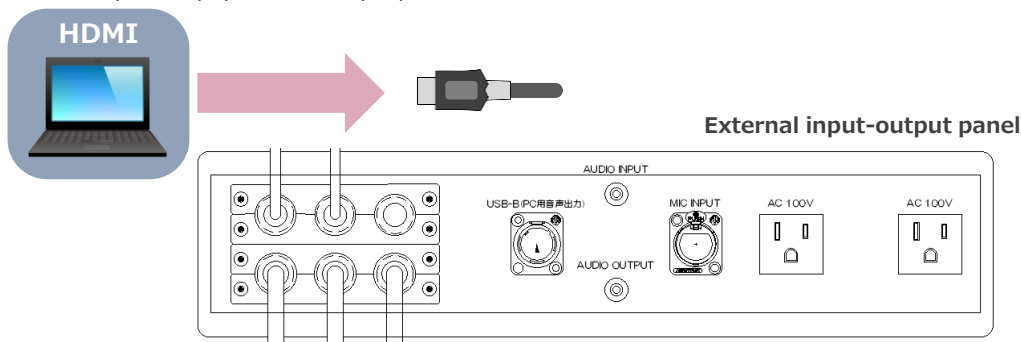

《Ex》 Windows 10》



It can please check the output in the settings on the display if you use the bring-in laptop.



Every time you press "Windows key" + "P" switch in orde

- **Only Laptop** : it only displays your laptop's screen.(no screen projection)
- **Copy** : it displays the same screen your laptop and screen.
- **Enlarge** : Your laptop and screen can use like the dual-screen.
- **Only second screen** : it only displays second screen.

\* It can use a "USB-HDMI conversion adapter" when using USB.



It can display the screen when you tap on the [Output Select] from the touch panel or select the [HDMI 1] / [HDMI 2] of the "switch panel".

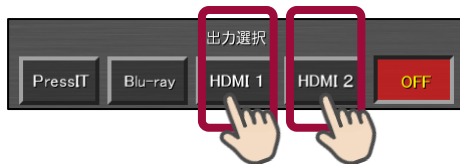

It connects the "Audio cable" -3.5Φ miniplug- to the "External input/output panel" and bring-in Audio devises.

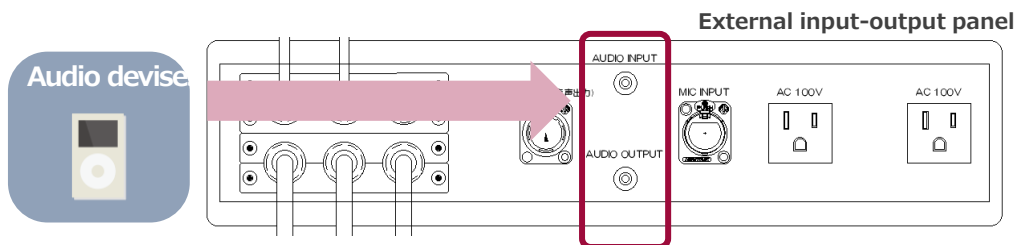

4-c Use the "Blu-ray player"

It pushes on the "tray open", inserts a disc and push on the "close button" with unit.



Its taps on the [Blu-ray] and playback(▶) on a Touch panel.

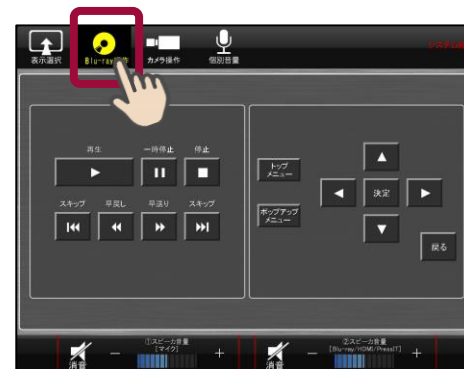

It can display the screen when you tap on the [Output Select] from the touch panel or select the [Blu-ray] of the "switch panel".

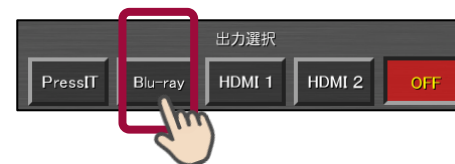

5 Adjust the volume

It can be adjusted the volume of the Microphone and video volume when you tap the bottom on the touch panel. And It can be adjusted individually. you can select "Individual volume" and operate.



To individual volume control screen

Whole amount adjustment

## 6 Web conferencing connection using a live switcher.

It can use the two cameras and microphone on the web conferencing apps.

Live switcher



Connecting  
\* Check that it is lit red.

Adjusting the Microphone

Select Camera's output

It connects the "USB cable" to the "USB-A of the External input/output panel" and your Laptop of the web conference.

After it, it can set the device of the application to be used as follows.

\* If you want to output the other party's voice in your room during a web conference, connect the "external input/output panel" and your laptop with an "HDMI cable".

External input-output panel

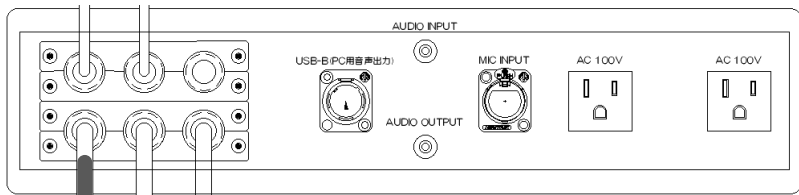

**Speaker**

MSD-6203

**Microphone**

VR-1HD

**Camera**

VR-1HD

It can select the digital audio interface with devices name, speaker and microphone if it uses audio output of the laptop.

\* But these USB for camera cannot connect to the other line.

## 7 Camera operation

It can operate of the "pan-tilt-zoom", "angle" and "Preset" with the touch panel.



※"Lectern" of the camera angle is set to the defaults.

It can see the camera's video from the "camera monitor"

## 8 Shut down the system

It taps on the [System off] . And it taps on the [Yes] after page changes

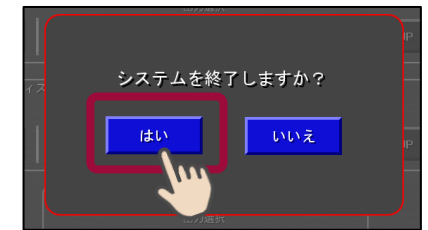
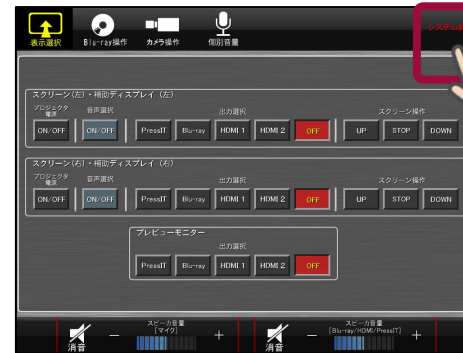

Close the door of the Wagon \* be locked

\* It could please be careful not to forget to retrieve your disc.

補足：タッチパネル不具合時の操作

Wagon - Top surface

① ⑥ switch panel

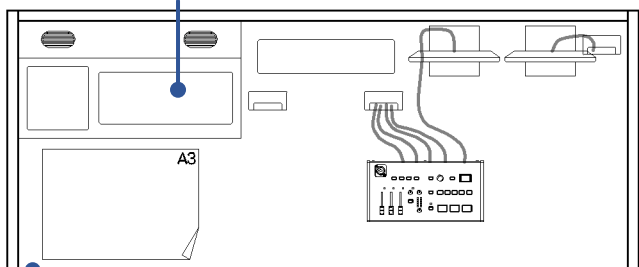

Emergency Switch (side of the wagon)

Switch the button  
If IC card reader don't work

Wagon (right side)

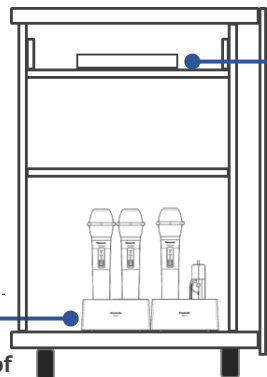

Remort Control of Blu-ray

③ Remort Control of Camera  
④ ⑤ Volume fader

Operation ordinally from the touch panel

- ① Select the Video Output to Screen
- ② Basic operation of "Blu-ray/DVD player"
- ③ Camera operation
- ④ Adjust the volume -Microphone/video volume-
- ⑤ Adjust the individual volume
- ⑥ Shut down the system



Homepage on the touch panel

① Select the Video Output to Screen

It can use the "Switch panel".

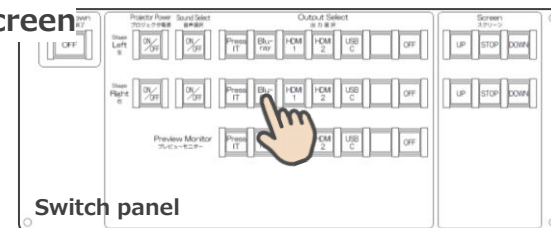

Switch panel

② Basic operation of "Blu-ray/DVD player"

It can operate with the remote control.



Remote control for blu-ray

③ Camera operation

It can operate with each of the remote control.

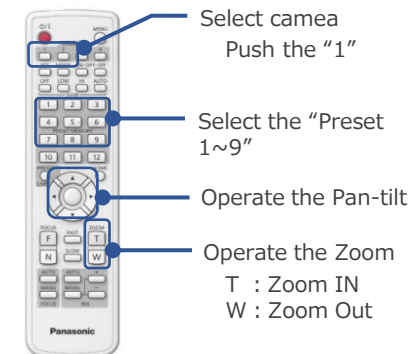

Remote control for Camera

④ ⑤ Adjust whole / individual volume -Microphone/video volume-

It connects the "LAN cable" around the bottom right of Wagon to the "Back of unit the volume fader".



Adjusting the each of volume with the fader

Volume fader



- ① Speaker volume (microphone)
- ② Speaker volume (Blu-ray/BYOD)
- ③ wireless handheld microphone1
- ④ wireless handheld microphone2
- ⑤ wireless handheld microphone3
- ⑥ wireless tie pin microphone
- ⑦ wired microphone
- ⑧ Audio IN

⑥ Shut down the system

It pushes the [Shut Down] on the Switch Panel.

\* It could please push the "Emergency Switch" in the case of working the system with "Emergency Switch".

