

Logging into the Integrated Authentication System

September 2025

ICT Office

Contents

1. Preparation	3
2. Login Procedure	3
2.1. For the First Login	3
2.2. After the First Time	7
3. Other	8

At Sophia University, system logins are conducted via an integrated authentication system (Single Sign-On, hereafter referred to as SSO) that incorporates multi-factor authentication. Multi-factor authentication enhances security by requiring additional authentication information beyond just an ID and password. It is necessary when accessing internal systems from external networks.

Note: Multi-factor authentication is not required when using the campus network (such as sophiawifi2019).

As of November 2025, the systems that use the Integrated Authentication System include:

- Loyola
- My Sophia
- Sophia Mail
- Moodle
- VPN
- Mailing List System
- Self-Learning Portfolio
- CaLabo MX
- My OPAC (Library OPAC)
- Zoom
- Certificate Issuance System
- Career Center System

1. Preparation

To log in to the integrated authentication system, a smartphone is required.

If you do not have a smartphone, please contact the ICT Office.

Please install the “Microsoft Authenticator” on your smartphone:



2. Login Procedure

2.1. For the First Login

Here are the steps for logging into the unified authentication system for the first time after multi-factor authentication has been introduced.

Initial setup is recommended on a PC, as it involves scanning a QR code displayed on the screen.

- ① Access the ICT Office website at <https://ccweb.cc.sophia.ac.jp/en/> and click the system icon to log in. Loyola is used as an example here, but the process is the same for all systems.



- ② The integrated authentication login screen will appear. Enter your ID (faculty/staff number) and Sophia ICT account password.

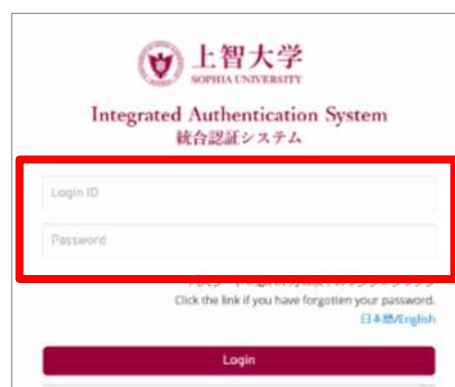

- ③ A QR code will be displayed. At this point, DO NOT scan the QR code with your smartphone's camera app.

※The QR code is shown only during the first login. From the second login onward. Please refer to page 4. Section “2-2. After the First Time.

※In case you have uninstalled “Microsoft Authenticator” after setting up multi-factor authentication and need to reconfigure it, please see section 3 “Other” on page 4.



上智大学
SOPHIA UNIVERSITY

Integrated Authentication System
統合認証システム

アカウントを有効にするにはモバイル・オーセンティクエーターのセットアップが必要です。(You need to set up Mobile Authenticator to activate your account.)

1. モバイルにアプリ [Microsoft Authenticator] をインストールしてください。(Please install the app "Microsoft Authenticator" on your mobile.)

2. アプリケーションを開き、バーコードをスキャンします。(Open the application and scan the barcode.)

QRコードが読み込めない場合こちらをクリック (Unable to scan?)

3. アプリケーションから提供されたワンタイムコードを入力し、送信をクリックしてセットアップを完了します。(Enter the one-time code provided by the application and click Submit to finish the setup.)

デバイス名を入力してください。(任意) (Provide a Device Name to help you manage your OTP devices.)

ワンタイムコード (One-time code) *

デバイス名 (Device Name)

Submit

- ④ Launch the “Authenticator” app on your smartphone.



- ⑤ When the app opens, tap “Accept” on the screen.



Microsoft respects your privacy

We collect required diagnostic data to keep the app secure and updated. This does not include any personal data.

Accept

[Microsoft Privacy Statement](#)

⑥ Tap “Continue”.



⑦ Tap “Scan a QR Code”.



⑧ A message will appear asking for camera access. Select “Allow” or “Only this time”.

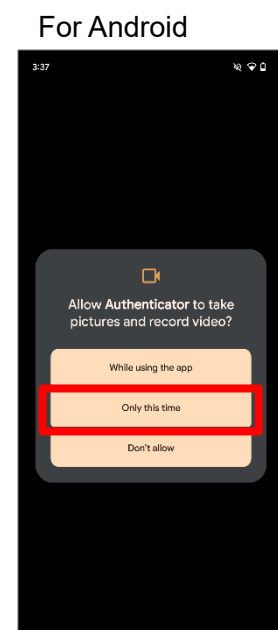
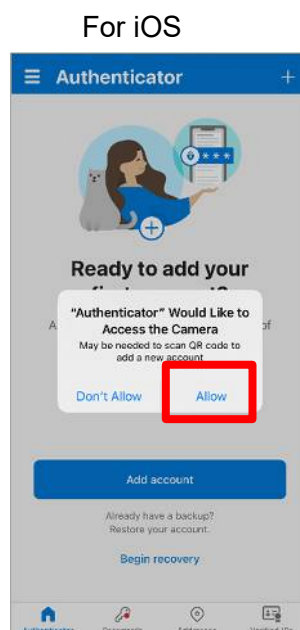

- ⑨ The QR code scanning screen will appear. Scan the QR code displayed on the Integrated Authentication System.

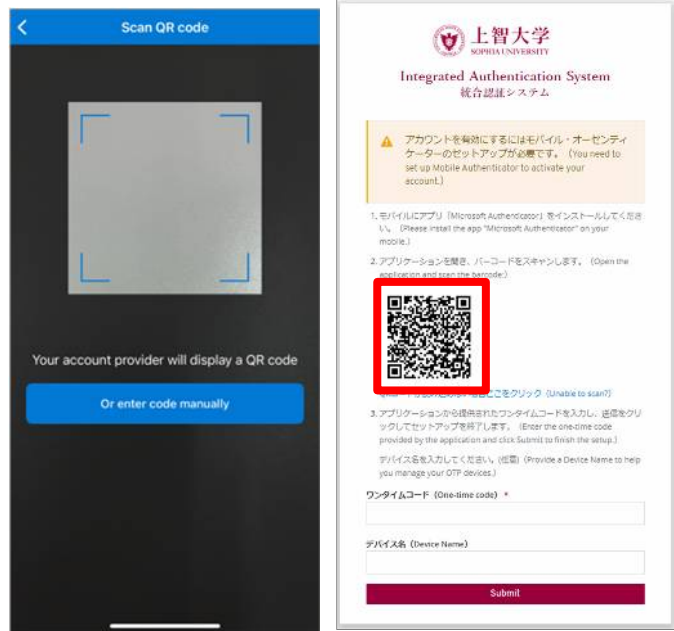

- ⑩ Once the QR code is scanned, a one-time code will appear under the “sophia” entry in the Microsoft Authenticator app. Enter this code in the “One-time code” field and tap “Submit”. Entering a device name is optional.

***No space between the two three-digit groups.**



- ⑪ Authentication is complete, and you will be logged into the system.



2.2. After the First Time

Here are the login steps for subsequent access.

- ① Access the ICT Office website at <https://ccweb.cc.sophia.ac.jp/en/> and click the system icon to log in. Loyola is used as an example here, but the process is the same for all systems.



- ② The integrated authentication login screen will appear. Enter your ID (faculty/staff number) and Sophia ICT account password.



- ③ The screen for entering a one-time code will appear. Please open the Microsoft Authenticator app on your smartphone and check the code.



- ④ Enter the one-time code displayed in Microsoft Authenticator app into the "One-time code" field.
***No space between the two three-digit groups.**



- ⑤ Authentication is complete, and you will be logged into the system.



3. Other

- If you have uninstalled “Microsoft Authenticator” after setting up multi-factor authentication and need to scan the QR code again, please contact ict-support@sophia.ac.jp. We will reset your settings so that the QR code can be displayed again.
 - If you do not have a smartphone, please contact the ICT Office by email.
 - Regarding Multi-Factor Authentication applications other than Microsoft Authenticator, while the ICT Office does not provide support for them, you are free to use them (e.g., Google Authenticator, Duo Mobile).
- However, please note that any issues that arise during initial setup or use must be resolved by the user.

Logging into the Integrated Authentication System
August 2025 Created a new document.
September 2025 Revised.
November 2025 Revised.

Author	Sophia University ICT-Office
Address	102-8554 Kioicho 7-1, Chiyoda-ku, Tokyo-to, Japan.
Phone	03(3238)3101
Website	http://ccweb.cc.sophia.ac.jp/

Sophia ICT

Search

