

# eduroam JP Federated ID Service

---

## Index

1. Overview .....	1
2. Account Issuance .....	1
3. Account Verification .....	6
4. How to Connect .....	7
4.1 Windows .....	7
4.2 Mac .....	8
4.3 iOS .....	10
4.4 Android .....	12
5. Obtaining a New Account / Troubleshooting .....	14
5.1 For Windows .....	14
5.2 For Mac .....	15
5.3 iOS .....	18
5.4 Android .....	18

---

## 1. Overview

The “eduroam JP Federated ID Service” is a service provided by NII (National Institute of Informatics) that issues account for members of educational and research institutions to connect to the wireless LAN (Wi-Fi) when visiting organizations participating in eduroam, both in Japan and overseas.

Issued accounts have expiration periods (up to 3 months for students, up to 12 months for faculty and staff). Up to 5 accounts can be issued at the same time. Please issue a new account yourself when renewal is needed.

## 2. Account Issuance

- ① Access the service (SP) provided by the Academic Access Management Federation.  
eduroam JP Federated ID Service Login Link (Japanese only):

<https://federated-id.eduroam.jp/>

- ② Open the above URL and click “Login”.

• [ログイン/Login](#)  GakuNin

- ③ Select “Sophia University” from the list of institutions or enter it directly.

**GakuNin**

### Select your Home Organisation

In order to access a service on host 'federated-id.eduroam.jp' you must authenticate yourself.

Select the Home Organisation you are affiliated with [dropdown menu] **Select** [Reset](#)

☐ Remember selection for this web browser session.  
☐ Remember selection permanently and bypass the WAYF service from now on.

**GakuNin** provides innovative, unique internet services for the Japanese universities and internet users.

---

**GakuNin**

### Select your Home Organisation

In order to access a service on host 'federated-id.eduroam.jp' you must authenticate yourself.

Sophia University [dropdown menu] **Select** [Reset](#)

☐ Remember selection for this web browser session.  
☐ Remember selection permanently and bypass the WAYF service from now on.

**GakuNin** provides innovative, unique internet services for the Japanese universities and internet users.

- ④ The Integrated Authentication System login screen will appear. Enter your ID and Sophia ICT account password. If prompted for a one-time code, enter the code and click [Login].

 **上智大学**  
SOPHIA UNIVERSITY

### Integrated Authentication System

統合認証システム

Login ID [input field]  
Password [input field]

パスワードを忘れた方は以下のリンクをクリック  
Click the link if you have forgotten your password.  
[日本語/English](#)

**Login**

 **上智大学**  
SOPHIA UNIVERSITY

### Integrated Authentication System

統合認証システム

ワンタイムコード (One-time code)  
[input field]

**Login**

※ログインができない場合は管理者にお問い合わせください。

- ⑤ When the screen changes, select the required items and click [Agree].



**上智大学**  
SOPHIA UNIVERSITY

**Integrated Authentication System**  
統合認証システム

The service you are trying to access:  
**eduroamJP 認証連携IDサービス**

Description provided by the service:  
学認と連携したeduroam用ID発行サービス

**Information that will be sent to the service**

o	Sophia University	<input checked="" type="checkbox"/>
eduPersonAffiliation	staff	<input checked="" type="checkbox"/>

☒ Check again on your next login

☐ Do not show the consent screen again unless the submitted values change

**Agree** Disagree

- ⑥ When the screen shown below appears, click ‘New ID/Password Account’.

## eduroamJP認証連携IDサービス メニュー / Menu

ログインID: EWITFIB3C3IN2Y77UUBD673VKEHAMU4R

本人用アカウント発行上限数:5

---

- [新規ID/Passwordアカウント発行 / New ID/Password Account](#)
- [発行済みID/Passwordアカウントの確認および失効 / Issued and revoke ID/Password](#)  
(発行済みアカウント数/Issued 0 : 有効アカウント数/Valid 0)
- [新規証明書\[EAP-TLS\]アカウント発行 / New Certificate \[EAP-TLS\] Account](#)
- [発行済み証明書アカウント\[EAP-TLS\]の確認および失効 / Issued and revoke Certificate \[EAP-TLS\] Account](#)  
(発行済みアカウント数/Issued 0 : 有効アカウント数/Valid 0)

- ⑦ After reviewing the Terms of Use, tick ‘Agreed’, and click ‘Proceed’.

### ID/Password発行

## サービス利用規約 / Terms of Use

下記のサービス利用規約に同意した上で、「同意します」にチェックを入れて「進む」ボタンを押してください。

大学共同利用機関法人 情報・システム研究機構 国立情報学研究所（以下、「研究所」という。）が提供する「eduroam JP認証連携IDサービス」（以下、「本サービス」という。）を利用するにあたり、本サービスの利用機関および利用者（以下、「利用者」という。）が遵守すべき事項を定めるものです。

#### 2. サービスの定義

本サービスは、利用機関のポリシーに基づいてeduroamを利用するために必要となる、IDおよびパスワード等（以下、「eduroam認証情報」という。）を発行するものであり、以下の機能を提供します。

- ・ eduroamアクセスポイントを介してネットワークに接続するためのeduroam認証情報を利用者に対して期間を限定して発行する機能
- ・ eduroamアクセスポイントを提供する学術機関あるいはISP等（以下、「eduroam提供機関」という。）において、eduroamアクセスポイントに本サービスで発行されたeduroam認証情報を用いて接続しようとする際に、認証要求を受け、eduroam認証情報の正誤を応答する機能

なお、発行されるeduroam認証情報には、利用者を特定する文字列は含みません（仮名アカウント）。

☒ 同意します / Agreed

ID/Password発行に進む / Proceed

- ⑧ Specify 'Since' and 'Duration', then click [Next].

**ID/Password発行**

**有効期限設定 / Duration of Use**

ログインID / Login ID:

発行済アカウント数 / Issued: 2

申請日 / Date of Issue (Today): 2026-01-14

有効期限を指定してください / Duration of Use

利用開始日 / Since: 2026 年(Y) 1 月(M) 14 日(D)

利用期間 / Duration: 1日(days)

アカウントメモ / Note:

確認 / Next

リセット / Reset

- ⑨ After confirming the item details, click [Submit].

有効期限を確認してください / Duration of Use

利用開始日時 / Since: 2026-01-14 00:00:00+0900

利用終了日時 / Until: 2026-01-14 23:59:59+0900

利用可能期間 / Period: 1日(days)

アカウントメモ / Note:

申請 / Submit

戻る / Back

- ⑩ Account information will be displayed.

**申請内容 / Duration of Use**

利用開始日時 / Since: 2026-01-14 00:00:00+0900

利用終了日時 / Until: 2026-01-14 23:59:59+0900

利用可能期間 / Period: 1日(days)

アカウントメモ / Note:

**eduroamアカウント情報 / Account Information**

eduroam ID:

eduroam Password:

(このアカウントが利用できるのは発行者本人のみです/This account is not for other than the issuer)

### 3. Account Verification

- ① Log in to the ‘eduroam JP Federated ID Service’ and click ‘Issued and revoke ID/Password’ from the menu.

**eduroamJP認証連携IDサービス メニュー / Menu**  
  
ログインID: EWITFI83C3IN2Y77UUBD673VKEHAMU4R  
本人用アカウント発行上限数:5  
  

- 新規ID/Passwordアカウント発行 / New ID/Password Account
- 発行済みID/Passwordアカウントの確認および失効 / Issued and revoke ID/Password**  
(発行済みアカウント数/Issued 0 : 有効アカウント数/Valid 0)
- 新規証明書[EAP-TLS]アカウント発行 / New Certificate [EAP-TLS] Account
- 発行済み証明書アカウント[EAP-TLS]の確認および失効 / Issued and revoke Certificate [EAP-TLS] Account  
(発行済みアカウント数/Issued 0 : 有効アカウント数/Valid 0)

- ② Issued Accounts will be displayed.

**ID/Password発行**  
**発行済みアカウント一覧 / Issued Accounts**

失効 / Revoke	eduroam-ID	Password	利用開始日 / Since	利用終了日 / Until	接続記録 / Log	アカウント メモ / Note	メモ修正 / Edit Note
<input type="checkbox"/>	@sophia.f.eduroam.jp ( )	( )	2026-01-14	2026-01-14	確認		Modify
<input type="checkbox"/>	@sophia.f.eduroam.jp ( )	( )	2025-12-15	2026-01-14	確認	学認テスト 用	Modify
<input type="checkbox"/>	@sophia.f.eduroam.jp		2025-10-13	2025-11-12		テスト用	修正

失効する / Revoke

アカウントを失効させる場合は、チェックを入れて「失効する」ボタンを押してください。

## 4. How to Connect

### 4.1 Windows

- ① Select 'eduroam' in the order shown below.

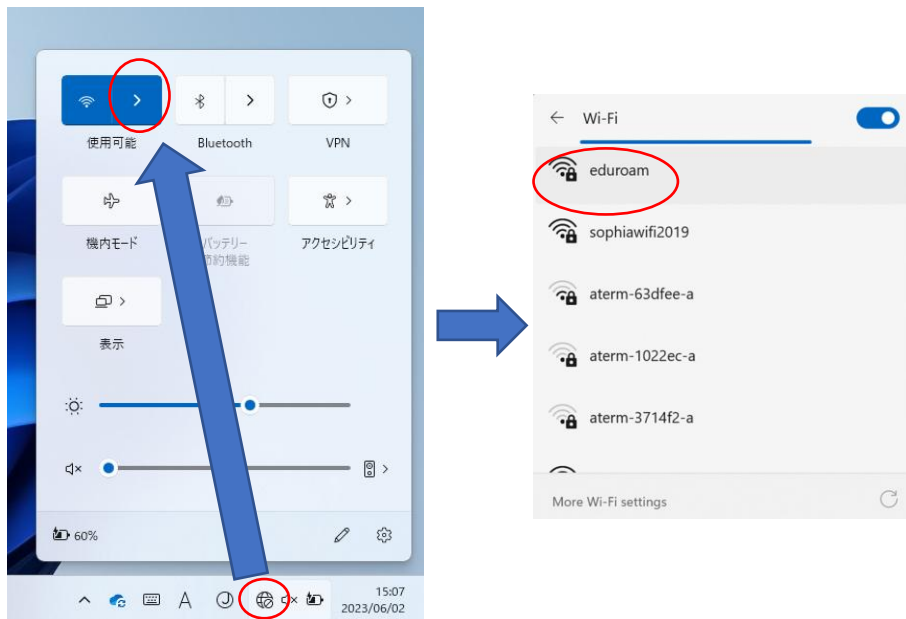

- ② Click [Connect], enter the account information obtained in '2. Account Issuance', and click 'OK'.

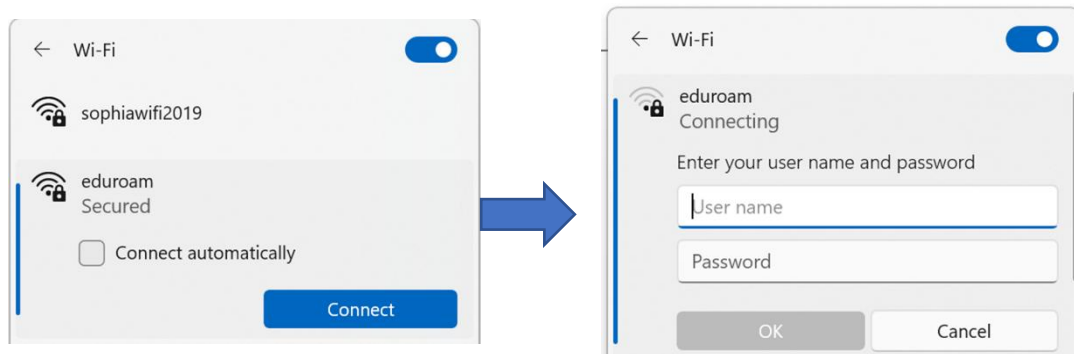

- ③ When 'Continue connecting?' is displayed, click [Connect].  
Connection is complete when 'eduroam' shows 'Connected'.



## 4.2 Mac

- ① Click the Wi-Fi icon, and then click 'Wi-Fi Settings'.

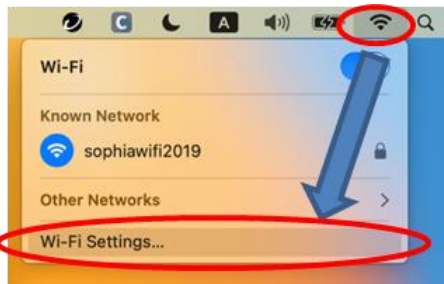

- ② Hover over 'eduroam' and click 'Connect'.

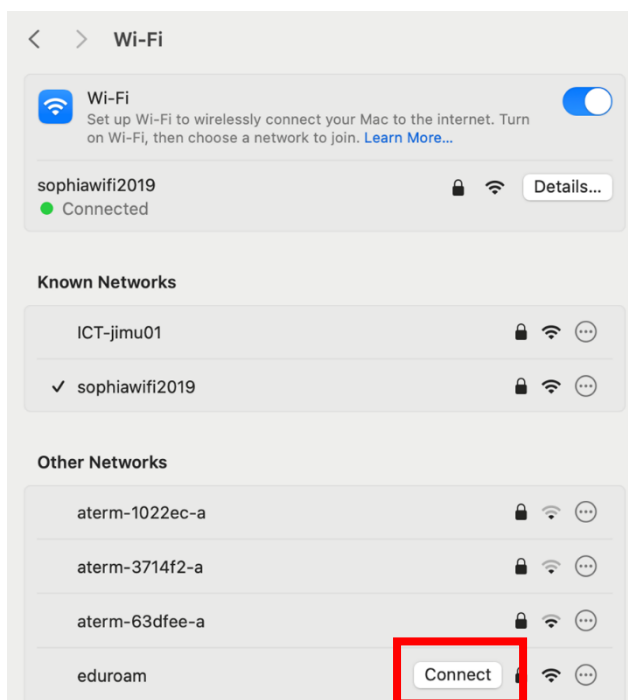

- ③ Enter the account information obtained in '2. Account Issuance', and click 'OK'.

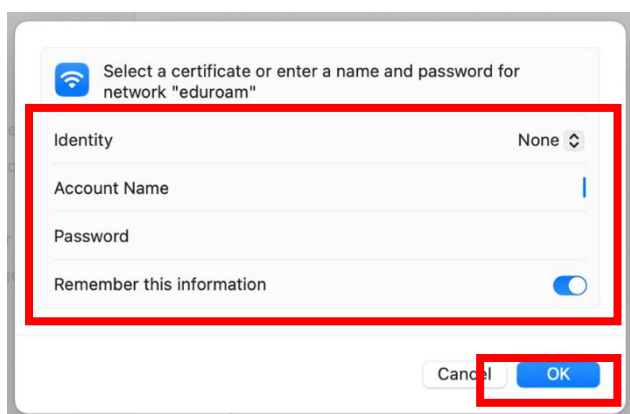

- ④ If the following message appears, click [Continue].

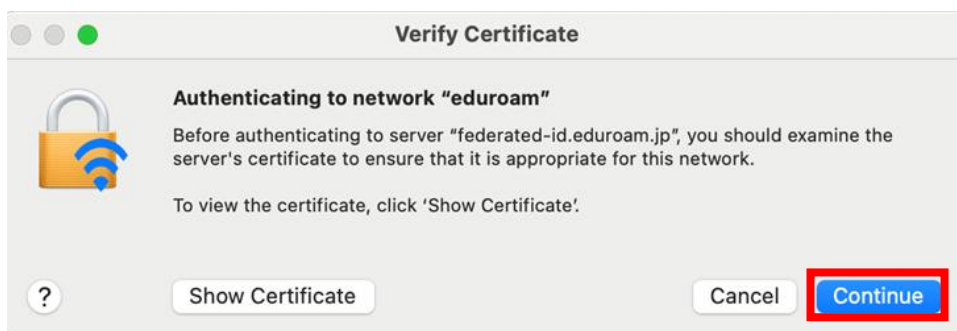

- ⑤ If the following message appears, enter the login password for the PC.

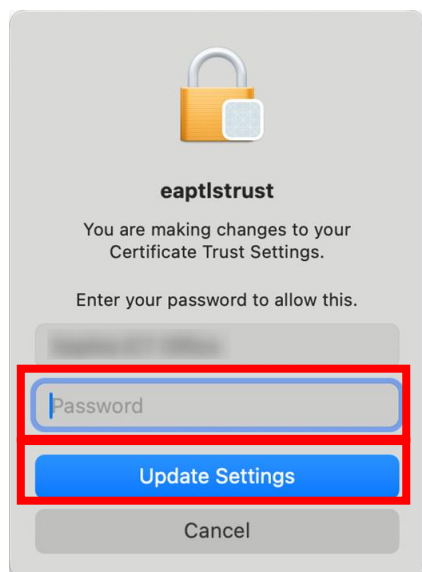

- ⑥ Connection is complete when 'eduroam' shows 'Connected'.

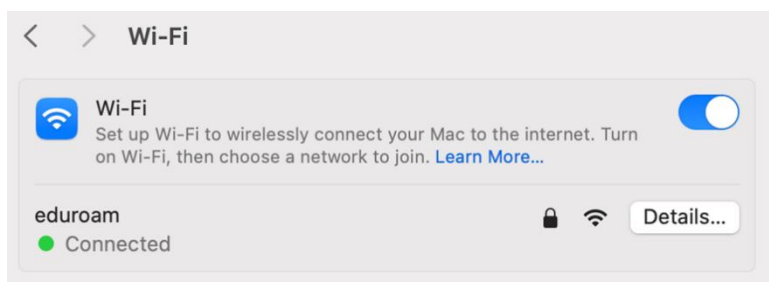

## 4.3 iOS

① Tap 'Settings' on the iPhone, then tap 'Wi-Fi'.

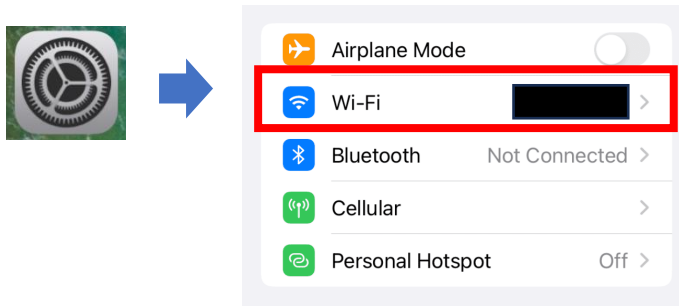

② From the Networks section, tap 'eduroam'.

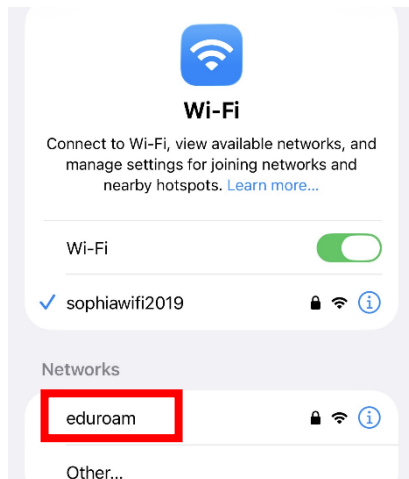

③ Enter the account information issued in '2. Account Issuance', then tap the "✓" icon.

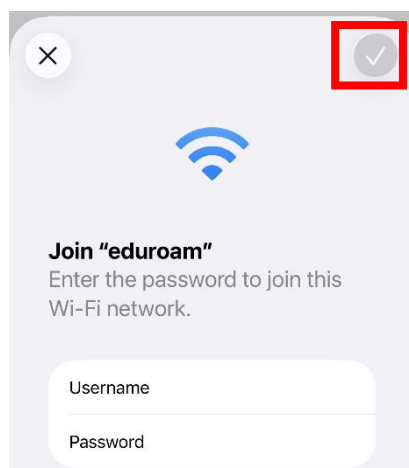

- ④ After confirming that 'federated-id.eduroam.jp' is displayed under [Certificate], tap 'Trust'.

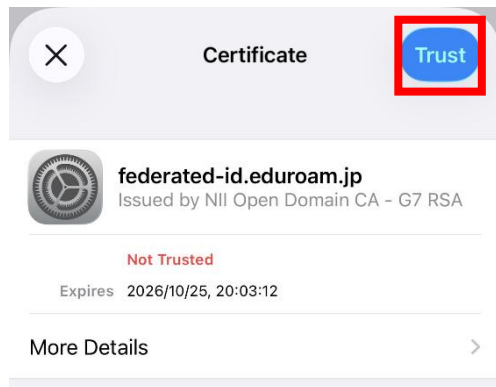

- ⑤ Once connected, a check mark appears to the left of 'eduroam'.

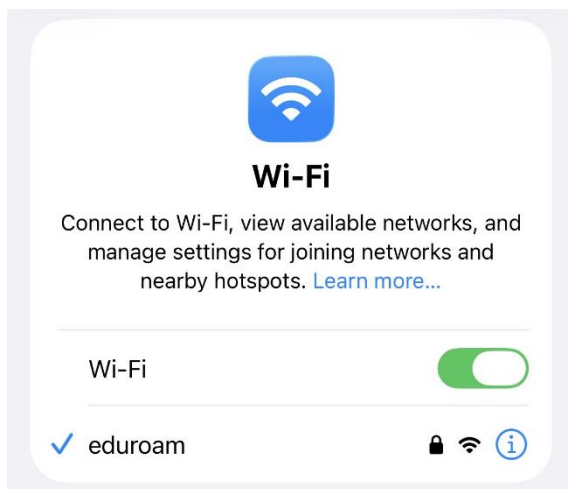

## 4.4 Android

① Tap Settings → Network & Internet → Internet in this order.



② If within the campus Wi-Fi area, 'eduroam' appears in the list of available networks. Tap it.

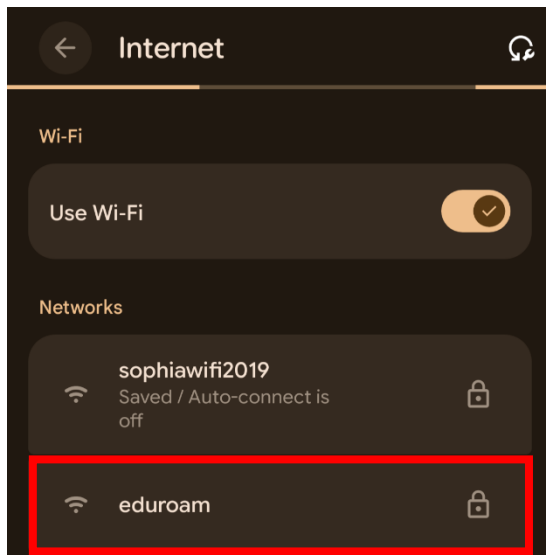

- ③ After setting each item to the values shown below, tap 'Connect' at the lower right.

EAP method	PEAP
Phase 2 authentication	MSCHAPV2
CA certificate	Use system certificates
Minimum TLS version	TLS v1.0 (Keep the default setting)
Domain	federated-id.eduroam.jp
Identity	ID issued in '2. Account Issuance'
Anonymous Identity	Leave this field blank
Password	Password issued in '2. Account Issuance'

← eduroam

EAP method  
PEAP ▾

Phase 2 authentication  
MSCHAPV2 ▾

CA certificate  
Use system certificates ▾

Minimum TLS version  
TLS v1.0 ▾

Online Certificate Status  
Do not verify ▾

Domain  
federated-id.eduroam.jp

Identity  
@sophia.f.eduroam.jp

Anonymous identity

Password\*  
.....

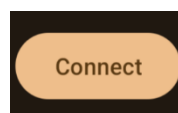

- ④ When connected, 'eduroam' changes to 'Connected'.

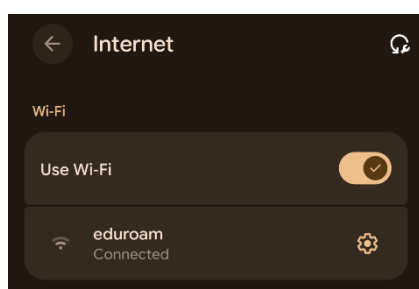

## 5. Obtaining a New Account / Troubleshooting

If a new eduroam account has been obtained or if the connection fails, delete the eduroam configuration and set it up again.

### 5.1 For Windows

- ① Open Wi-Fi settings in the following order.

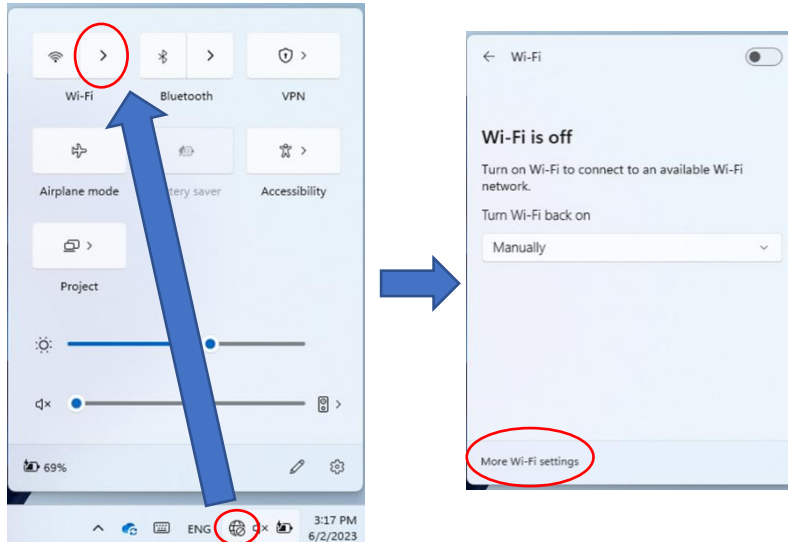

- ② Remove "eduroam" from "Manage known networks".

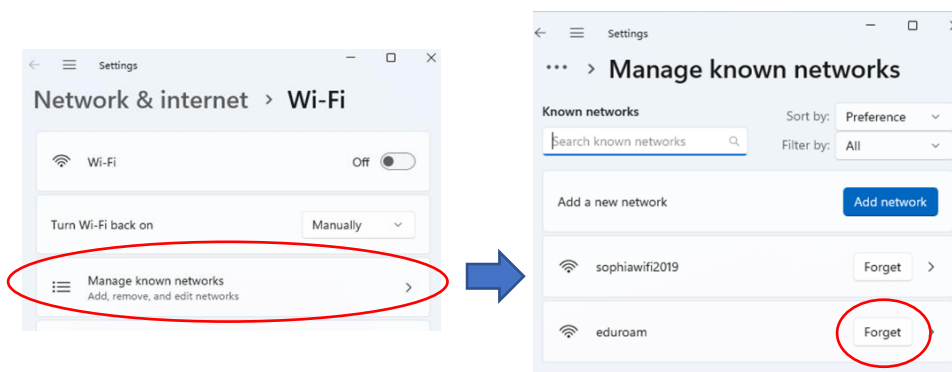

- ③ Restart the PC and set up the eduroam again.

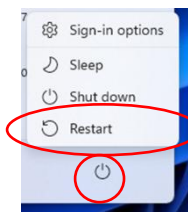

## 5.2 For Mac

- ① Click the magnifying glass icon at the top of the screen and enter 'key'.  
When 'Keychain Access' appears, click it.

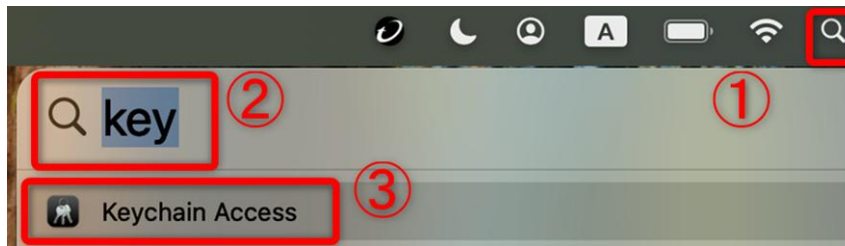

- ② Click 'Open Keychain Access'.

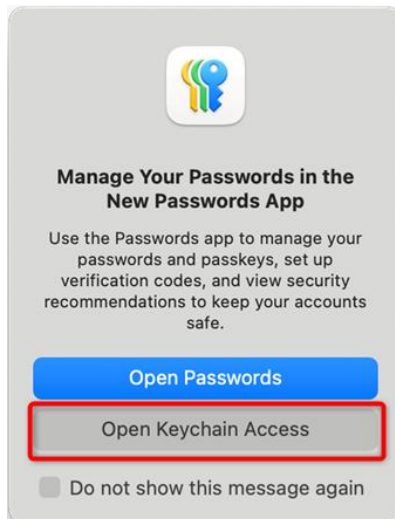

- ③ Enter the login password for your PC.

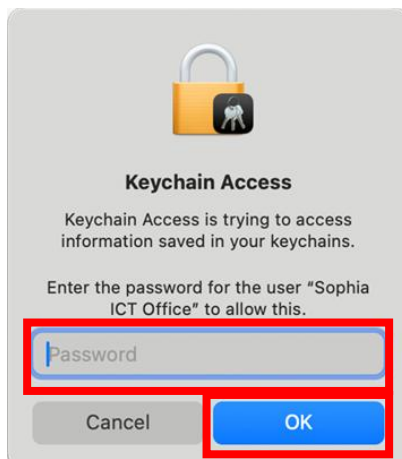

- ④ Click 'System', then enter 'eduroam' in the search bar, and click 'eduroam' using a two-finger click. (If it does not appear, proceed to step ⑥).

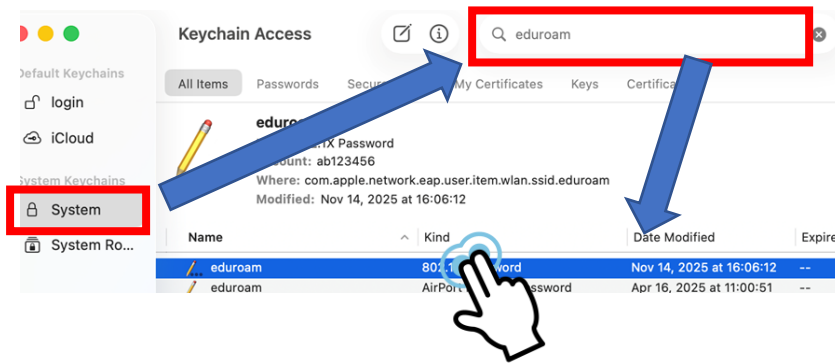

- ⑤ Select 'Delete "eduroam"', and when the pop-up appears, click [Delete]. Confirm that 'eduroam' has been removed, and then close Keychain Access.

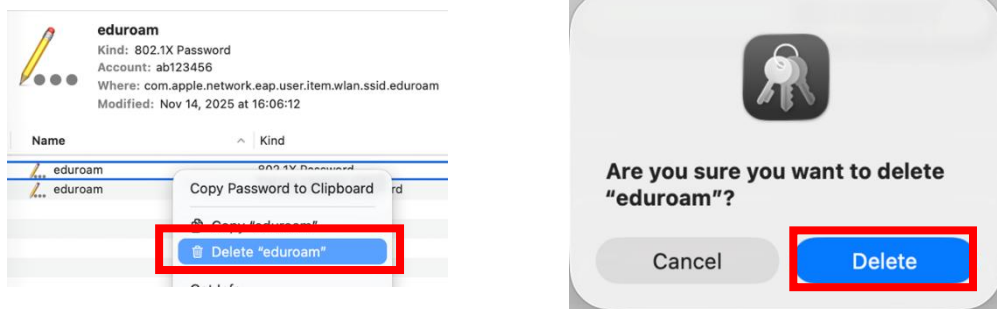

- ⑥ Click the Wi-Fi icon, and then click 'Wi-Fi Settings'.

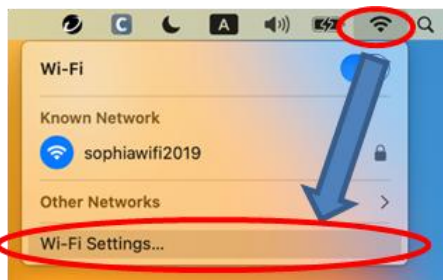

- ⑦ Click the '...' next to 'eduroam', and select 'Forget This Network'.

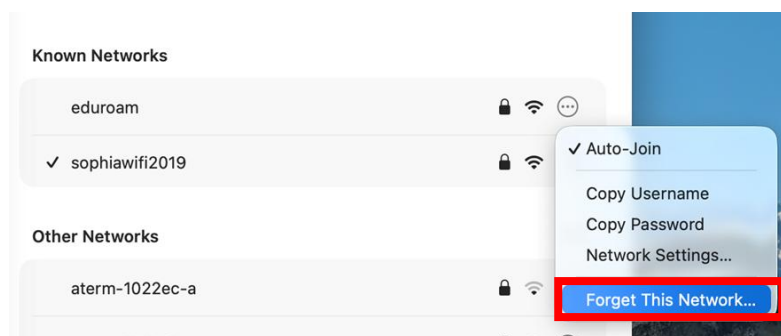

- ⑧ When the pop-up shown below appears, click 'Forget'.

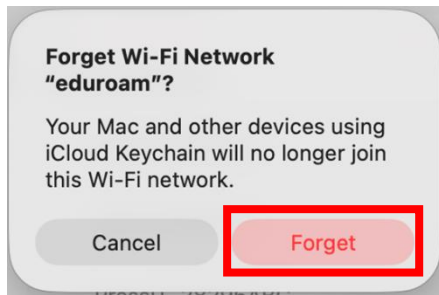

- ⑨ Restart the device, and then set up eduroam again.

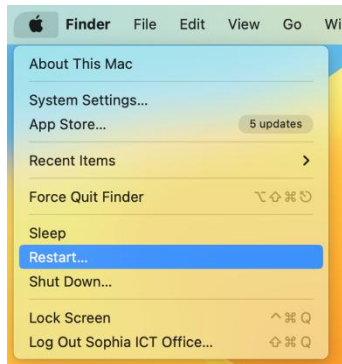

## 5.3 iOS

- ① In the Wi-Fi settings, tap the 'i' icon next to 'eduroam', then tap 'Forget This Network'.

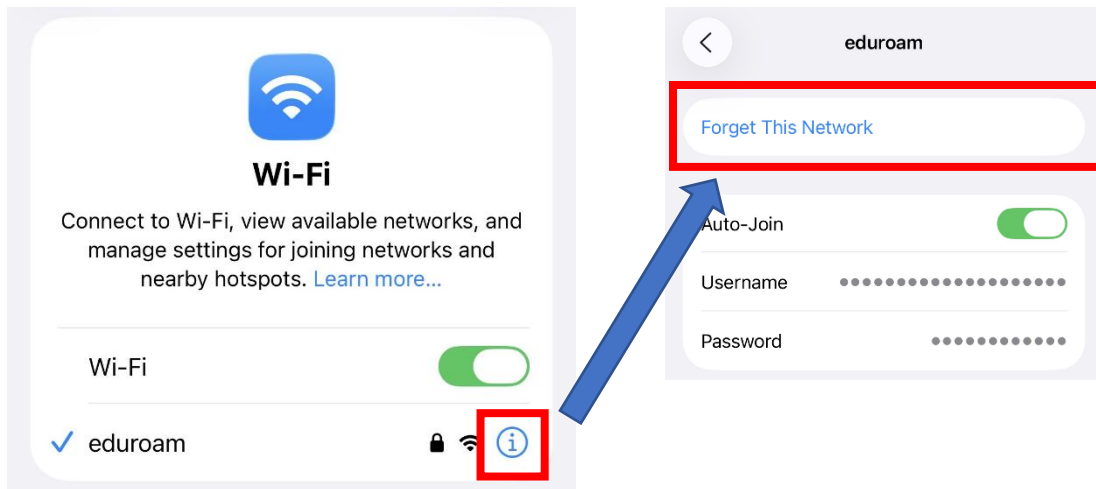

- ② Restart the device and then set it up again.

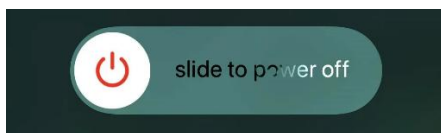

## 5.4 Android

- ① In the Internet screen, tap the gear icon next to 'eduroam', then tap 'Forget'.

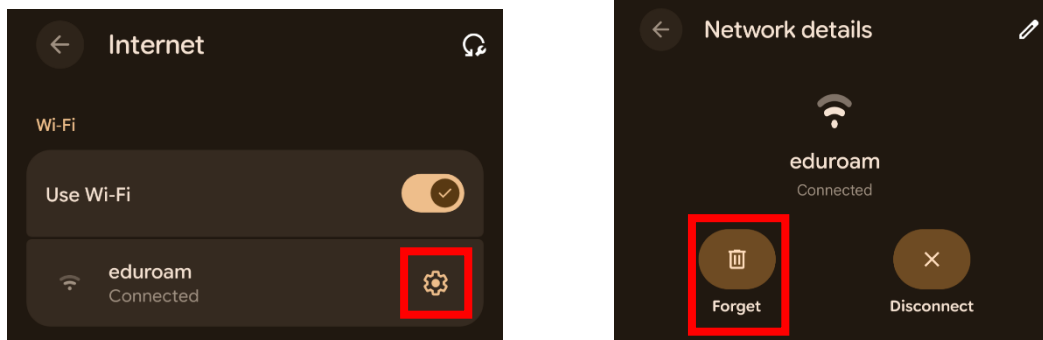

- ② Restart the device and then set it up again.

